

**Allproof Pipe Wrap**  
**Plastic Pipe in Concrete Floor**  
 PVC, HDPE, PP-R, PP-MD

System/FPA Register ID# FC671

<b>Products</b>	Allproof Pipe Wrap
<b>Application</b>	Fire stopping of plastic pipe in rigid floor
<b>Construction</b>	Minimum floor thickness of 120mm and comprise aerated concrete or concrete

**Fire Classification:**

<u>In 150mm floor slab, PVC pipe</u>	
40mm, max aperture 62mm	FRR -/120/120
50mm, max aperture 72mm	FRR -/120/120
65mm, max aperture 87mm	FRR -/180/180
80mm, max aperture 102mm	FRR -/120/120
100mm, max aperture 127mm	FRR -/120/120
150mm, max aperture 192mm	FRR -/90/90

<u>In 150mm floor slab, HDPE pipe</u>	
50mm, max aperture 67mm	FRR -/120/120
56mm, max aperture 73mm	FRR -/120/120
63mm, max aperture 80mm	FRR -/120/120
75mm, max aperture 92mm	FRR -/120/120
90mm, max aperture 107mm	FRR -/120/120
110mm, max aperture 127mm	FRR -/120/120
150mm, max aperture 192mm	FRR -/180/180
(includes Allproof Perforated Ring)	

<u>In 150mm floor slab, PP-R pipe</u>	
40mm, max aperture 57mm	FRR -/120/120
75mm, max aperture 92mm	FRR -/120/120
110mm, max aperture 127mm	FRR -/120/120

<u>In 120mm floor slab, PP-MD Raupiano pipe</u>	
40mm, max aperture 57mm	FRR -/120/120
50mm, max aperture 67mm	FRR -/120/120

**INSTALLATION INSTRUCTIONS:**

1. Position fire wrap around circumference of pipe and remove backing from the self adhesive strip and join ends together.
2. Slide wrap into position ensuring wrap is located entirely within depth of the floor. The wrap should be flush with the underside of the floor.
3. If there is a space between the concrete and the outer side of the wrap and above the wrap, backfill the space with mortar.
4. The polyethylene sleeve can be removed and intumescent strip taped in place if the core hole is very tight.

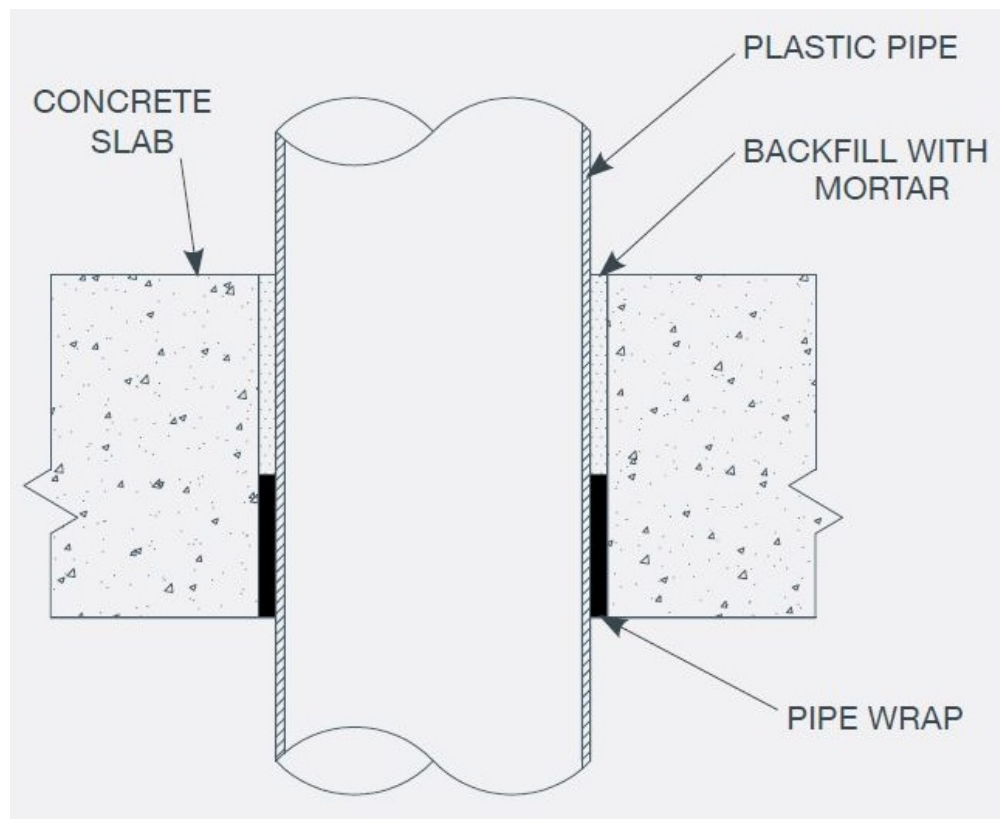

As a part of our policy of on-going product development and testing, we reserve the right to modify, alter or change product specifications without giving notice. All information contained in this document is given in good faith and is provided for guidance only. Any drawings provided are for illustrative purposes only. As Firestop Centre has no control over the methods or competence of installation and of prevailing site conditions, no warranties, expressed or implied, is intended to be given as to the actual performance of the product mentioned or referred to herein and no liability whatsoever will be accepted for any loss, damage or injury arising from the use of the information given.

Sheet size:	Drawn date & no:
<b>A4</b>	28/7/22

Scale:	Drawn by:
<b>NTS</b>	G.P